

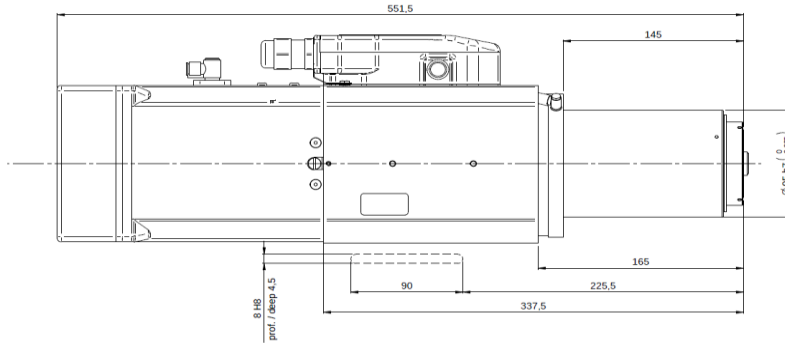

Electrospindle ATC 6.6Kw 24.000 rpm
QE-1F 6.6/12 24 63F NL CB

QE.000.L01

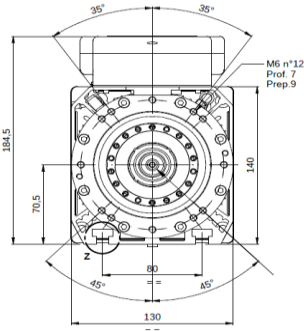

Prestazioni - Performances

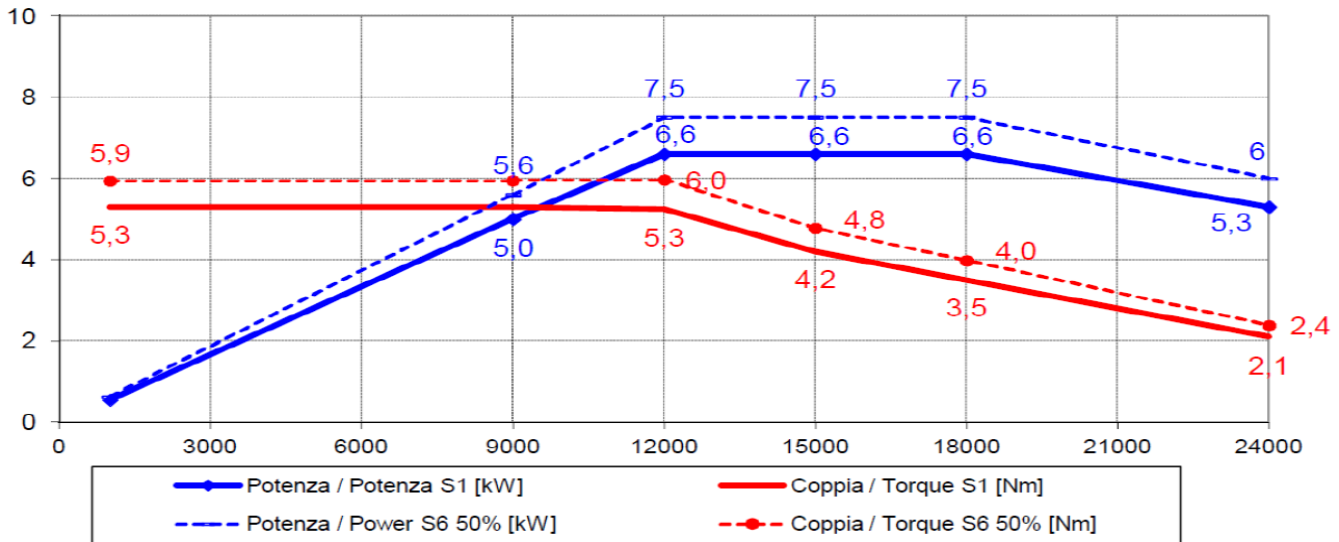

Specifiche tecniche/ Technical Specifications

Tipologia elettromandrino / Electrospindle type

Asincrono-4 poli / Synchronous-4poles

Attacco utensile / Tool interface

HSK 63F

Velocità rotazione max / Max speed

24000 rpm

Raffreddamento / cooling

Aria con elettroventola 24V DC / Air by electrofan 24V DC

Cuscinetti / Ball bearings

Ceramici / Ceramic

Lubrificazione cuscinetti / Bearings lubrication

Grasso a vita / Grease long life

Connessione pneumatiche / Pneumatic connection

Sblocco uten. / Release. tool: E6 6÷6.5 bar

Potenza max. (S1 - S6) / Max. Power.(S1 - S6)

Pressurizzazione / Air seal. E6 6÷6.5 bar

Coppia max. (S1 - S6) / Max. Torque (S1 - S6)

Soffio cono-aria utensile / Taper cleaning-air tool E4 6÷6.5 bar

Corrente (S1 - S6) / Current (S1 - S6)

6.6 kW @12000 Rpm (S1) / 7.5 kW @ 12000 Rpm (S6)

Tensione / Voltage

17,8 Nm (S1) / 20,1 Nm (S6)

Rotazione / Rotation

5.3 A (S1) / 6 A (S6)

Azionamento / Supply

400 V

Sensoristica / Sensors

CW – CCW

Peso / Weight

Con inverter / By inverter

S1 Afferraggio utensile / S1 Tool lock

S2 Pinza aperta / S2 Open clamp

S3 Rotazione albero / S3 Spindle rotation

23 kg